

TM 11-6625-202-24P

TECHNICAL MANUAL

ORGANIZATIONAL, DIRECT SUPPORT, AND GENERAL
SUPPORT MAINTENANCE
REPAIR PARTS AND SPECIAL TOOLS LISTS
(INCLUDING DEPOT MAINTENANCE REPAIR PARTS AND SPECIAL TOOLS)
FOR

TEST SET, RELAY TS-1775/U
(NSN 6625-00-064-6096)

This publication is a courtesy quick copy
from the UNITED STATES ARMY
PUBLICATIONS CENTER, ST. LOUIS, MISSOURI,
to meet your needs while we are replenish-
ing our regular stock.

HEADQUARTERS, DEPARTMENT OF THE ARMY

4 JANUARY 1978

**ORGANIZATIONAL, DIRECT SUPPORT, AND GENERAL SUPPORT MAINTENANCE
REPAIR PARTS AND SPECIAL TOOLS LISTS
(INCLUDING DEPOT MAINTENANCE REPAIR PARTS AND SPECIAL TOOLS)
FOR**

**TEST SET, RELAY TS-1775/U
(NSN 6625-00-064-6096)**

Current as of 21 September 1977

REPORTING OF ERRORS

You can improve this manual by recommending improvements using DA Form 2028-2 (Test) located in the back of the manual. Simply tear out the self addressed form, fill it out as shown on the sample, fold it where shown, and drop it in the mail.

If there are no blank DA Form 2028-2 (Test) in the back of your manual, use the standard DA Form 2028 (Recommended Changes to Publications and Blank Forms) and forward to the Commander, US Army Electronics Command, ATTN: DRSEL-MA-Q, Fort Monmouth, NJ 07703.

In either case a reply will be furnished direct to you.

Table of Contents

		Page	Illus Figure
S ECTION	I. Introduction	1	
	II. Repair parts list	5	
Group	00 Test Set, Relay TS-1775/U	5	1-4
SECTION	III. Special tools list (Not applicable)		
	IV. National stock number and part number index	14	

* This manual **supersedes** TM 11-6625-202-24P, 9 March 1976.

SECTION I

INTRODUCTION

1. Scope

This manual lists spares and repair parts; special tools; special test, measurement, and diagnostic equipment (TMDE), and other special support equipment required for performance of organizational, direct support, and general support maintenance of the TS-1775/U. It authorizes the requisitioning and issue of spares and repair parts as indicated by the source and maintenance codes.

2. General

This Repair Parts and Special Tools List is divided into the following sections:

a. Section II. Repair Parts List. A list of spares and repair parts authorized for use in the performance of maintenance. The list also includes parts which must be removed for replacement of the authorized parts. Parts lists are composed of functional groups in numeric sequence, with the parts in each group listed in figure and item number sequence.

b. Section III. Special Tools List. Not applicable.

c. Section IV. National Stock Number and Part Number Index. A list, in National item identification number (NIIN) sequence, of all National stock numbers (NSN) appearing in the listings, followed by a list, in alphameric sequence, of all part numbers appearing in the listings. National stock numbers and part numbers are cross-referenced to each illustration figure and item number appearance.

3. Explanation of Columns

a. Illustration. This column is divided as follows:

(1) *Figure number.* Indicates the figure number of the illustration on which the item is shown.

(2) *Item number.* The number used to identify item called out in the illustration.

b. Source, Maintenance, and Recoverability (SMR) Codes.

(1) *Source code.* Source codes indicate the manner of acquiring support items for maintenance, repair, or overhaul of end items. Source codes are entered in the first and second positions of the Uniform SMR Code format as follows:

<i>Code</i>	<i>Definition</i>
PA-Item procured and stocked for anticipated or known usage.	
XD-A support item that is not stocked. When required, item will be procured through normal supply channels.	

NOTE

Cannibalization or salvage may be used as a source of supply for any items source coded above except those coded XA and aircraft support items as restricted by AR 700-42.

(2) *Maintenance code.* Maintenance codes are assigned to indicate the levels of maintenance authorized to USE and REPAIR support items. The maintenance codes are entered in the third and fourth positions of the Uniform SMR Code format as follows:

(a) The maintenance code entered in the third position will indicate the lowest maintenance level authorized to remove, replace, and use the support item. The maintenance code entered in the third position will indicate one of the following levels of maintenance:

<i>Code</i>	<i>Application/Explanation</i>
O-Support item is removed, replaced, used at the organizational level.	
H-Support item is removed, replaced, used at the general support level.	

(b) The maintenance code entered in the fourth position indicates whether the item is to be repaired and identifies the lowest maintenance level with the capability to perform complete repair (i. e., all authorized maintenance functions). This position will contain one of the following maintenance codes:

<i>Code</i>	<i>Application Explanation</i>
H-The lowest maintenance level capable of complete repair of the support item is the general support level.	
Z-Nonreparable. No repair is authorized.	

(3) *Recoverability code.* Recoverability codes are assigned to support items to indicate the disposition action on unserviceable items. The recoverability code is entered in the fifth position of the Uniform SMR Code format as follows:

<i>Recoverability codes</i>	<i>Definition</i>
Z-Nonreparable item. When unserviceable, con-	

demn and dispose at the level indicated in position 3.

H-Reparable item. When uneconomically reparable, condemn and dispose at the general support level.

c. National Stock Number. Indicates the National stock number assigned to the item and will be used for requisitioning purposes.

d. Part Number. Indicates the primary number used by the manufacturer (individual, company, firm, corporation, or Government activity), which controls the design and characteristics of the item by means of its engineering drawings, specifications, standards, and inspection requirements to identify an item or range of items.

NOTE

When a stock numbered item is requisitioned, the repair part received may have a different part number than the part being replaced.

e. Federal Supply Code for Manufacturer (FSCM). The FSCM is a 5-digit numeric code listed in SB 708-42 which is used to identify the manufacturer, distributor, or Government agency, etc.

f. Description. Indicates the Federal item name and, if required, a minimum description to identify the item.

g. Unit of Measure (U/M). Indicates the standard of basic quantity of the listed item as used in performing the actual maintenance function. This measure is expressed by a two-character alphabetical abbreviation (e.g., ea, in, pr, etc). When the unit of measure differs from the unit of issue, the lowest unit that will satisfy the required units of measure will be requisitioned.

h. Quantity Incorporated in Unit. Indicates the quantity of the item used in the breakout shown on

the illustration figure, which is prepared for a functional group, subfunctional group, or an assembly.

4. Special Information

The following publications pertain to the TS-1775/U and its components:
TM 11-6625-202-14, Test Set, Relay TS-1775/U

5. How to locate Repair Parts

a. When National stock number or part number is unknown.

(1) *First.* Using the table of contents, determine the functional group within which the item belongs. This is necessary since illustrations are prepared for functional groups and listings are divided into the same groups.

(2) *Second.* Find the illustration covering the functional group to which the item belongs.

(3) *Third.* Identify the item on the illustration and note the illustration figure and item number of the item.

(4) *Fourth.* Using the Repair Parts Listing, find the figure and item number noted on the illustration.

b. When National stock number or part number is known.

(1) *First.* Using the Index of National Stock Numbers and Part Numbers, find the pertinent National stock number or part number. This index is in NIIN sequence followed by a list of part numbers in alphameric sequence, cross-referenced to the illustration figure number and item number.

(2) *Second.* After finding the figure and item number, locate the figure and item number in the repair parts list.

6. Abbreviations

Not applicable.

(Next printed page is 4.)

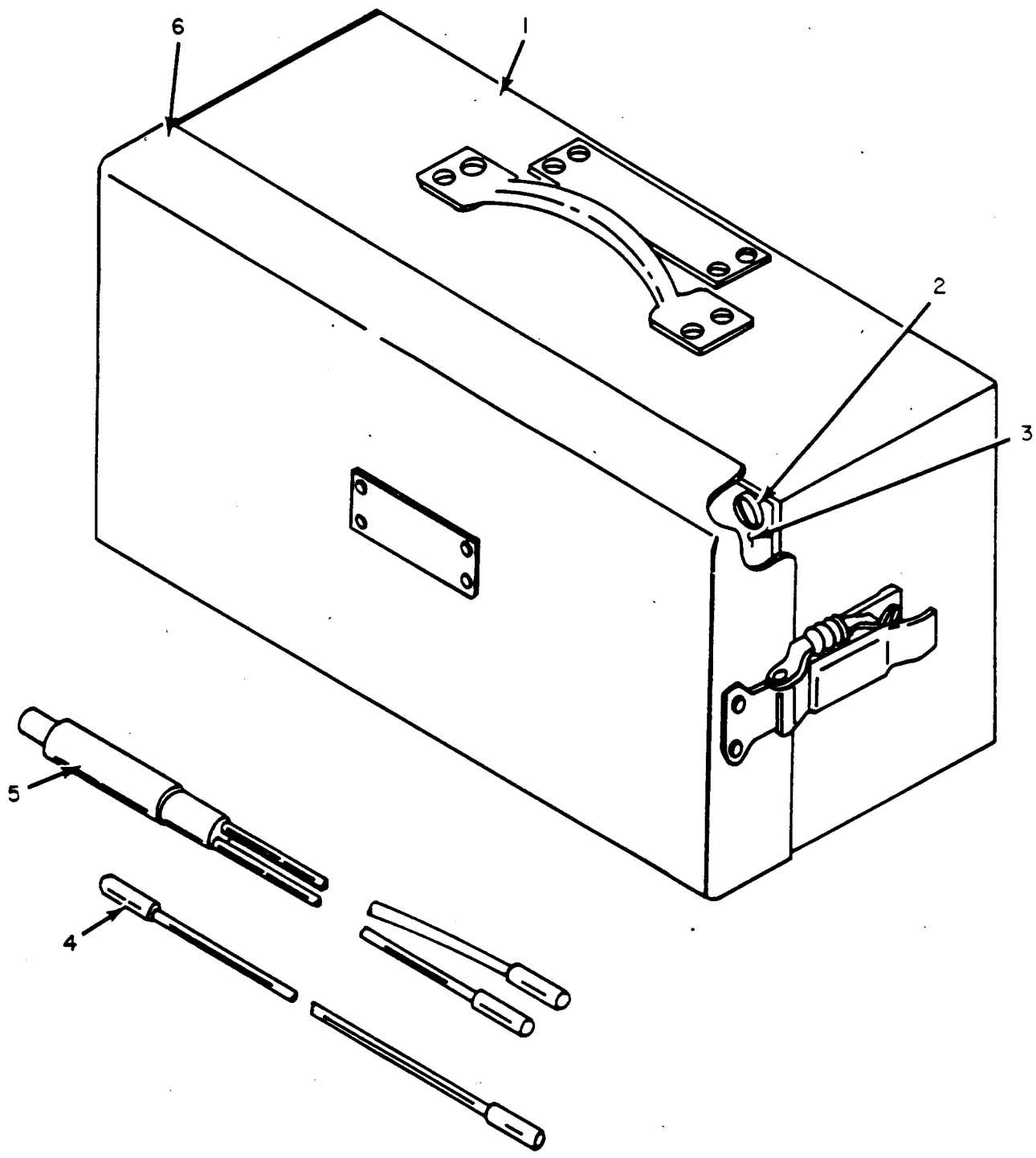

ELOCQ001

Figure 1. Test Set, Relay TS-1775/U.

SECTION II

TM11-6625-202-24P

(1)		(2)	(3)	(4)	(5)	(6)	(7)	(8)
ILLUST	TIO	SMR CODE	NATIONAL STOCK	PART NUMBER	FSCN	DESCRIPTION	QTY	INC
(a) FIG NO.	(b) ITE NC							
						GROUP 00TESTSET, RELAYTS-1775/U		
1		0HMH		M0288076	3006	CASE, TEST SET	EA	1
1		DHZZ		S35245-55	3690	SCREW, MACHINE	EA	4
1		DHHH		M0288079	3006	CHASSIS ASSEMBLY	EA	1
1		AHZZ	1995-00-756-500	M855377	3006	CORD ASSEMBLY, ELECTRICAL	EA	4
1		AHZZ	1995-00-756-501	M855378	3006	CORD ASSEMBLY, ELECTRICAL	EA	1
1		AHHH	1625-01-028-129	MC288077	1006	COVER ASSEMBLY	EA	1
						5		

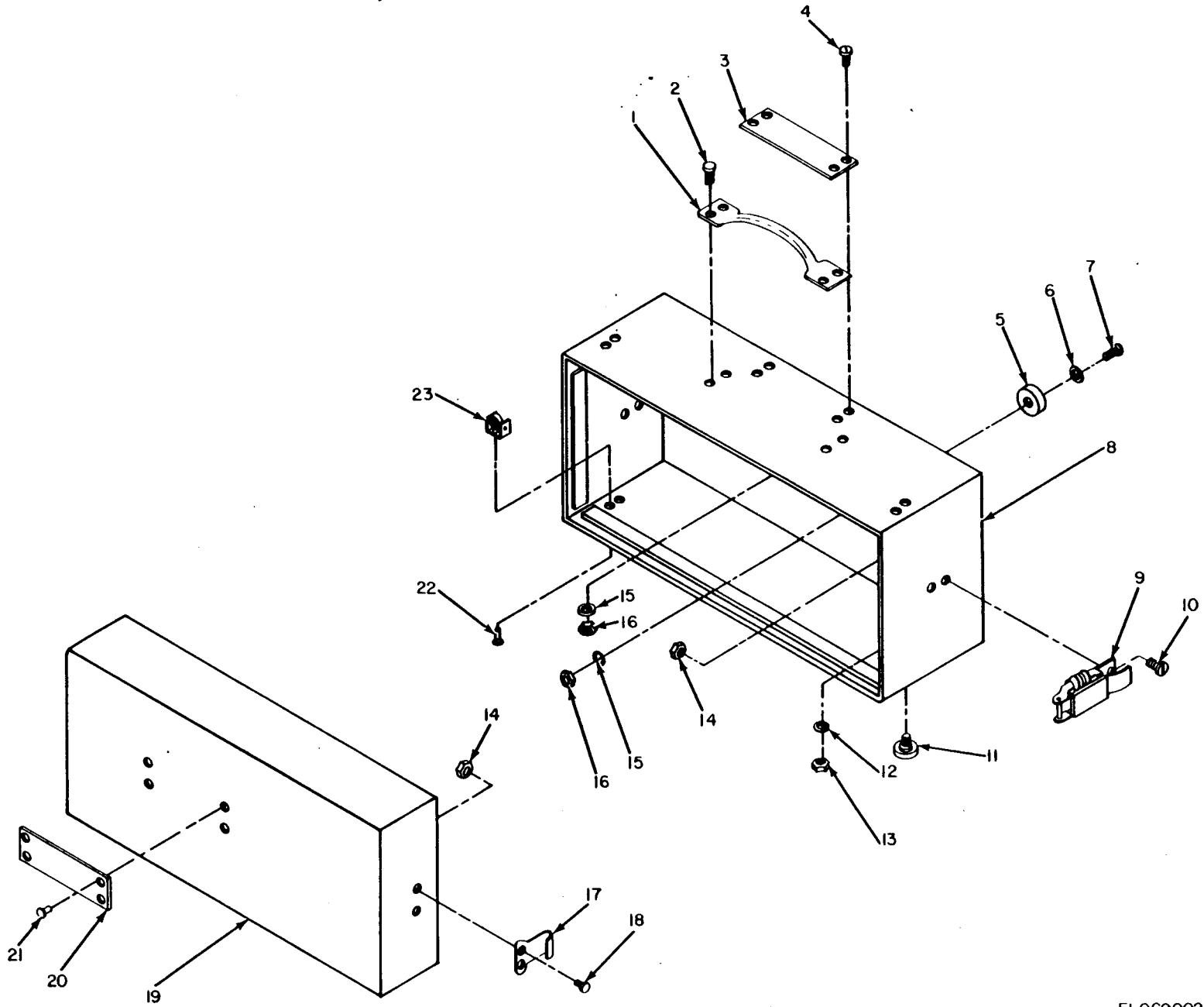

Figure 2. Test Set, Relay TS-1775/U, Case and Cover.

ELOC002

SECTION II

TM11-6625-202-24P

(1) ILLUSTRATION (a) FIG NO.	(2) TOP (b) ITEM NO.	(3) SMR CODE	(4) NATIONAL STOCK NUMBER	(5) PART NUMBER	(6) DESCRIPTION	(7) U/M	(8) QTY INC IN UNIT
2		XDHZZ		SMD288076-2	1006: HANDLE, BAIL	EA	1
2		PAHZZ	1305-00-059-4550	MS35190-235	1690: SCREW, MACHINE	EA	4
2		PAHZZ	1905-00-205-0770	SC017269-2	1006: PLATE, IDENTIFICATION	EA	1
2		PAHZZ	1305-00-889-3131	4S35206-203	1690: SCREW, MACHINE	EA	4
2		XDHZZ		SMD288076-1	1006: FOOT	EA	4
2		PAHZZ	1310-00-809-854	4S27183-7	1690: WASHER, FLAT	EA	4
2		PAHZZ	1305-00-984-6192	MS35206-244	1690: SCREW, MACHINE	EA	4
2		XDHZZ		SC044977	1006: CASE, BOTTOM	EA	1
2		PAHZZ	1340-00-205-515	SC020648	1006: CATCH, LUGGAGE	EA	2
2	1	PAHZZ	1305-00-043-588	4S35225-27	1690: SCREW, MACHINE	A	4
2	1	XDHZZ		SMD288076-3	1006: PAD	A	4
2	1	PAHZZ	1310-00-045-329	4S35338-42	1690: WASHER, SPLIT	A	4
2	1	PAHZZ	1310-00-934-975	4S35649-282	1690: NUT, PLAIN, HEXAGON	A	4
2	1	PAHZZ	1310-00-905-845	4S21083N06	1690: NUT, SELF-LOCKING, HEXAGON	A	8
2	1	PAHZZ	1310-00-543-5060	MS35338-39	1690: WASHER, SPLIT	A	8
2	1	PAHZZ	1310-00-934-973	MS35649-222	1690: NUT, PLAIN, HEXAGON	A	8
2	1	PAHZZ	1340-00-680-370	SC020650	1006: STRIKE, CATCH	A	2
2	1	PAHZZ	1305-00-958-5453	MS35190-266	1690: SCREW, MACHINE	A	4
2	1	PAHZZ	1625-01-017-543	SMC146095	1006: COVER, TEST SET	A	1
2	2	XDHZZ		SMC288078	1006: PLATE, IDENTIFICATION	A	1
2	2	PAHZZ	1320-00-721-5244	4S16535-77	1690: RIVET, TUBULAR	A	4
2	2	PAHZZ	1320-00-817-072	4S16535-53	1690: RIVET, TUBULAR	A	8
2	2	XDHZZ		SMD288076-4	1006: NUT, SELFLOCKING	A	4

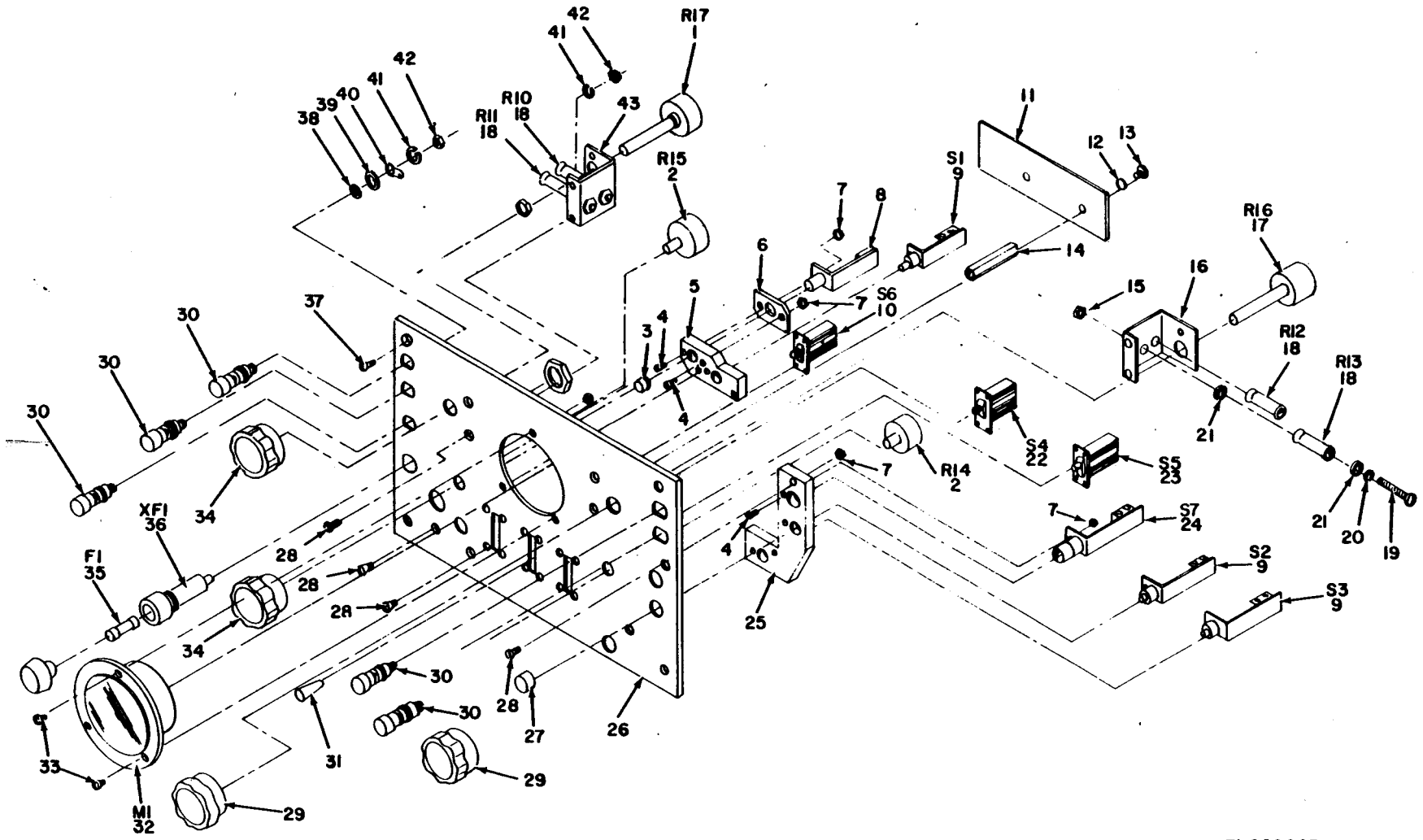

ELOCQ003

Figure 3. Test Set, Relay TS-1775/U, Front Panel Assembly.

(1)		(2)	(3)	(4)	(5)	(6)	(7)	(8)
ILLUSTRATION		SMR CODE	NATIONAL STOCK NUMBER	PART NUMBER	FSCM	DESCRIPTION	USABLE ON CODE	QTY
(a) FIG NO.	(b) ITEM NO.							INC
3	1	PAHZZ	5905-00-195-2366	RP151F K502KK	81349	RESISTOR,VARIABLE	EA	1
3	2	XDHZZ		RA30NAFD501AK	81349	RESISTOR,VARIABLE	EA	2
3	3	XDHZZ		SCB44992	80063	BUSHING,SLEEVE	EA	1
3	4	PAHZZ	5305-00-059-8251	MS 35214-26	96906	SCREW,MACHINE	EA	10
3	5	XDHZZ		SMB288084	80063	INSULATOR,SPACER	EA	1
3	6	XDHZZ		SMB288083	80063	INSULATOR,SPACER	EA	1
3	7	XDHZZ		SMD288079-13	80063	NUT,SELF-LOCKING	EA	6
3	8	XDHZZ		SMD288079-3	80063	JACK,TELEPHONE	EA	1
3	9	XDHZZ		SCB44997	80063	SWITCH,ROTARY	EA	3
3	10	XDHZZ		SMC359200-2	80063	SWITCH,LEVER	EA	1
3	11	XDHZZ		SMB288080	80063	TERMINAL BOARD ASS EMBLY	EA	1
3	12	PAHZZ	5310-00-082-140	MS27183-6	96906	WASHER,FLAT	EA	2
3	13	PAHZZ	5305-00-206-371	MS35214-25	96906	SCREW,MACHINE	EA	2
3	14	XDHZZ		SCB44991	80063	SPACER,SLEEVE	EA	2
3	15	XDHZZ		MS20365-832	96906	NUT,SELF-LOCKING	EA	4
3	16	XDHZZ		SCB44987	80063	BRACKET,MOUNTING	EA	1
3	17	PAHZZ	5905-00-195-2674	RP151FK103KK	81349	RESISTOR,VARIABLE	EA	1
3	18	PAHZZ	5905-00-636-9919	RW31V201	81349	RESISTOR,FIXED,WIREWOUND	EA	4
3	19	XDHZZ		MS35225-53	96906	SCREW,MACHINE	EA	4
3	20	PAHZZ	5310-00-809-8544	MS27183-7	96906	WASHER,FLAT	EA	4
3	21	XDHZZ		SCB44998	80063	WASHER,NONMETALLIC	EA	8
3	22	XDHZZ		SMC359200-3	80063	SWITCH,LEVER	EA	1
3	23	XDHZZ		SMC359200-1	80063	SWITCH,LEVER	EA	1
3	24	XDHZZ		SCB44996	80063	SWITCH,ROTARY	EA	1
3	25	XDHZZ		SMB146091	80063	INSULATOR,SPACER	EA	1
3	26	PAHZZ	6625-01-013-2591	SNC146088	80063	PANEL,FRONT	EA	1
3	27	XDOZZ		SCB44997-1	80063	KNOB	EA	4
3	28	XDHZZ		AN505083-4	88044	SCREW,MACHINE	EA	12
3	29	PAQZZ	5355-01-016-3557	SCB44993-2	80063	KNOB	EA	2
3	30	XDHZZ		SMB359219	80063	POST,BINDING	EA	5
3	31	XDHZZ		4610-1	76572	HANDLE,SWITCH	EA	3
3	32	PAHZZ	6625-00-537-5599	SMD288082	80063	AMMETER	EA	1
3	33	PAHZZ	5305-00-984-4988	MS35206-228	69	SCREW,MACHINE	EA	3
3	34	PAQZZ	5355-01-016-2953	SCB44993-1	80063	KNOB	EA	2
3	35	PAQZZ	5920-00-284-9455	F02B125V1-8A	81349	FUSE,CARTRIDGE	EA	1
3	36	PAHZZ	5920-00-892-9311	FHM2661	81349	FUSEHOLDER	EA	1
3	37	PAHZZ	5305-00-957-6266	MS35190-252		SCREW,MACHINE	EA	4
3	38	PAHZZ	5310-00-194-0637	MS9320-10	96906	WASHER,FLAT	EA	5
3	39	XDHZZ		SMD288079-17	80063	WASHER,NONMETALLIC	EA	5
3	40	XDHZZ		SMD288079-12		TERMINAL LUG	EA	5

(a) FIG NO.	(b) ITEM NO.	(2) CODE	(3) NATIONAL STOCK NUMBER	(4) PART NUMBER	(5) FSCN	(6) DESCRIPTION	(7) U/M	(8) QTY INC IN UNIT
3	4	XDHZJ		MS35333-21	9690	WASHER, LOCK	EA	9
3	4	PAMZJ	310-00-934-9762	MS35649-286	9690	NUT, PLAIN, HEXAGON	EA	9
3	4	XDHZZ		SC844986	8006	BRACKET, MOUNTING	EA	1
						10/11 (blank)		

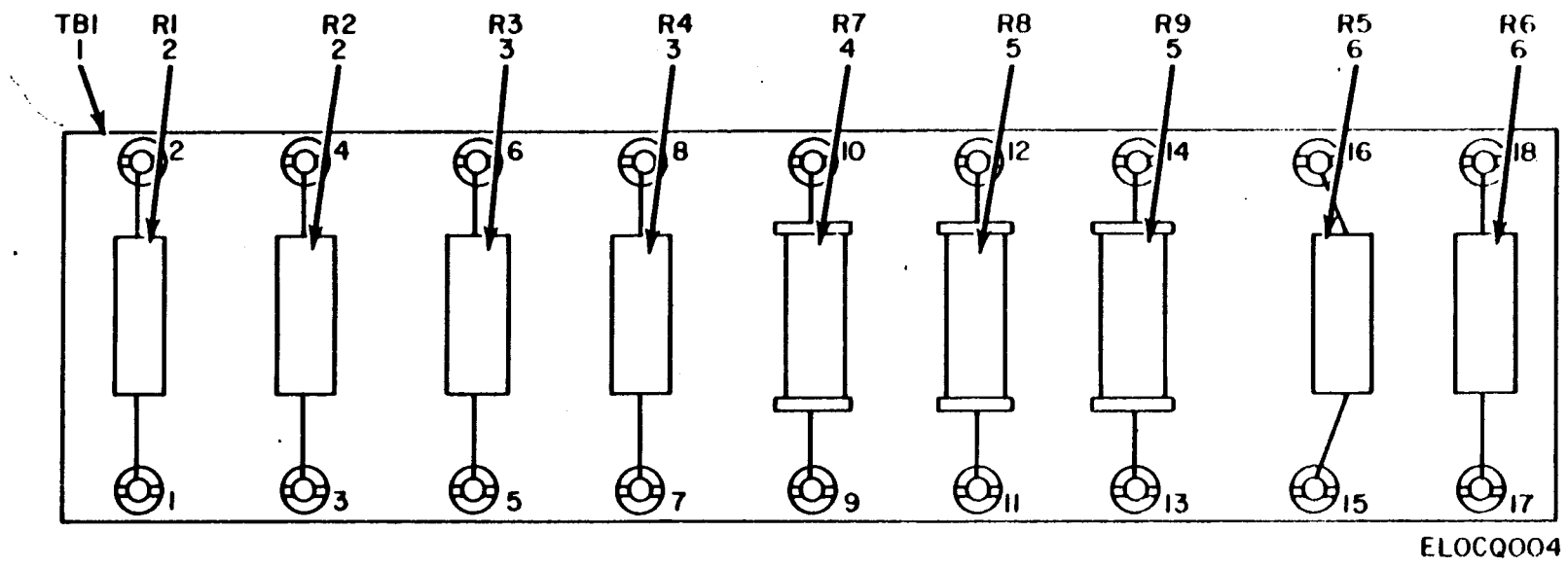

ELOCQ004

Figure 4. Test Set, Relay TS-1775/U, Terminal Board Assembly.

(1) ILLUSTRATION		(2)	(3)	(4)	(5)	(6)	(7)	(8)
(A) FIG NO.	(B) ITEM NO.	SMR CODE	NATIONAL STOCK NUMBER	PART NUMBER	FSCM	DESCRIPTION	USABLE ON CODE U/M	QTY INC IN UNIT
4	1	XDHZZ		SMB288080-1	80063	TERMINAL BOARD	EA	1
4	2	PAHZZ	5905-00-244-8259	RCR32G752JS	81349	RESISTOR, FIXED, COMPOSITION	EA	2
4	3	PAHZZ	5905-00-104-8352	RCR32G153JS	81349	RESISTOR, FIXED, COMPOSITION	EA	2
4	4	XDHZZ		SMB359217-2	80063	RESISTOR, FIXED, FILM	EA	1
4		XDHZZ		SMB359217-1	80063	RESISTOR, FIXED, FILM	EA	2
4	6	PAHZZ	5905-00-106-9354	RCR32G302JS	81349	RESISTOR, FIXED, COMPOSITION	EA	2

NOTE : LATEST NATIONAL STOCK NUMBER AND PART NUMBER ASSIGNMENTS ARE INCLUDED AT END OF INDEX

STOCK NUMBER	FIGURE NO.	ITEM NO.	STOCK NUMBER	FIGURE NO.	ITEM NO.
5305-00-043-5885	2	10	5995-00-756-5013	1	5
5310-00-045-3299	2	12	5310-00-809-8544	2	6
5310-00-082-1404	3	12	5310-00-809-8544	3	20
5905-00-195-2366	3	1	5320-00-817-0728	2	22
5905-00-195-2674	3	17	5920-00-892-9311	3	36
5340-00-205-5159	2	9	6625-01-013-2591	3	26
6625-00-537-5599	3	32	5355-01-016-2953	3	34
5905-00-636-9919	3	18	5355-01-016-3557	3	29
5340-00-680-3701	2	17	6625-01-017-5439	2	19
5995-00-756-5007	1	4	6625-01-028-1292	1	6

PART NUMBER	FSCM	FIG. NO.	ITEM NO.	PART NUMBER	FSCM	FIG. NO.	ITEM NO.
AN505UB3-4	88044	3	28	SCB44998	80063	3	21
FHN26G1	81349	3	36	SCD1 7269-2	80063	2	3
FO28125V1-8A	81349	3	35	SCD20648	80063	2	9
MS16535-53	96906	2	22	SCD20650	80063	2	17
MS16535-77	96906	2	21	SCD44977	80063	2	8
MS20365-832	96906	3	15	SMB146091	80063	3	25
MS27183-6	96906	3	12	SMB288080	80063	3	11
MS27183-7	96906	2	6	SMB288080-1	80063	4	1
MS27183-7	96906	3	20	SMB288083	80063	3	6
MS35225-27	96906	2	10	SMB288084	80063	3	5
MS35225-53	96906	3	19	SMB359217-1	80063	4	5
				SMB359217-2	80063	4	4
				SMB55377	80063	1	4
				SMB55378	80063	1	5
				SMC1 46088	80063	3	26
				SMC146095	80063	2	19
MS35245-55	96906	1	2	SMC288077	80063	1	6
MS35333-21	96906	3	41	SMC288078	80063	2	20
MS35338-42	96906	2	12	SMC359200-1	80063	3	23
MS35649-222	96906	2	16	SMC359200-2	80063	3	10
MS35649-282	96906	2	13	SMC359200-3	80063	3	22
RA30NAFD501AK	81349	3	2	SMD288076	80063	1	1
RP151 FK103KK	81349	3	17	SMD288076-1	80063	2	5
RP151 FK502KK	81349	3	1	SMD288076-2	80063	2	1
RW31V201	81349	3	18	SMD288076-4	80063	2	23
SCB44986	80063	3	43	SMD288079	80063	1	3
SCB44987	80063	3	16	SMD288079-12	80063	3	40
SCB44991	80063	3	14	SMD288079-13	80063	3	7
SCB44992	80063	3	3	SMD288079-17	80063	3	39
SCB44993-1	80063	3	34	SMD288079-3	80063	3	8
SCB44993-2	80063	3	29	SMD288082	80063	3	32
SCB44996	80063	3	24				
SCB44997	80063	3	9	4610-1	76572	3	31
SCB44997-1	80063	3	27				

LATEST NATIONAL STOCK NUMBER ASSIGNMENTS

STOCK NUMBER	FIG. NO.	ITEM NO.	STOCK NUMBER	FIG. NO.	ITEM NO.
5305-00-059-4550	2	2	5310-00-905-8451	2	14
5905-00-104-8352	4	3	5310-00-934-9762	3	42
9905-00-205-0770	2	3	5305-00-958-5453	2	18
5905-00-244-8259	4	2	5305-00-984-4988	3	33
5310-00-543-5060	2	15	5305-00-984-6192	2	7
5320-00-721-5244	2	21			

LATEST PART NUMBER ASSIGNMENTS

PART NUMBER	FSCM	FIG. NO.	ITEM NO.	PART NUMBER	FSCM	FIG. NO.	ITEM NO.
MS35190-235	96906	2	2	MS35338-39	96906	2	15
MS35190-266	96906	2	18	MS35649-286	96906	3	42
MS35206-228	96906	3	33	RCR32G153JS	81349	4	3
MS35206-244	96906	2	7	RCR32G752JS	81349	4	2
MS35214-26				SMB359219	80063	3	30

ADDITIONAL LATEST NATIONAL STOCK NUMBER ASSIGNMENTS

STOCK NUMBER	FIG. NO.	ITEM NO.	STOCK NUMBER	FIG. NO.	ITEM NO.
5305-00-059-8251					
5905-00-106-9354	4	6	5305-00-889-3118	2	4
5310-00-194-0637	3	38	5310-00-934-9757	2	13
5305-00-206-3716	3	13	5310-00-934-9738	2	16
5920-00-284-9455	3	35	5305-00-957-6266	3	37

ADDITIONAL LATEST PART NUMBER ASSIGNMENTS

PART NUMBER	FSCM	FIG. NO.	ITEM NO.	PART NUMBER	FSCM	FIG. NO.	ITEM NO.
MS21083N06	96906	2	14	MS9320-10	96906	3	38
MS35190-252	96906	3	37	RCR32G302JS	81349	4	6
MS35206-203	96906	2	4	SMD288076-3	80063	2	11
MS35214-25	96906	3	13				

TM 11-6625-202-24P

By Order of the Secretary of the Army:

BERNARD W. ROGERS
General, United States Army
Chief of Staff

Official:

J. C. PENNINGTON
Brigadier General, United States Army
The Adjutant General

Distribution:

.Active Army:

HISA (Ft Monmouth) (33)	Sig Dep (1)
USAINSCOM (2)	Sig FL DMS (1)
COE (1)	Units org under fol TOE:
TSG (1)	(1 cy each)
USAARENBD (1)	7
DARCOM (1)	7-100
TRADOC (2)	11-15
OS Maj Comd (4)	11-16
TECOM (2)	11-18
USACC (4)	11-36
MDW (1)	11-37
Armies (2)	11-38
Corps (2)	11-39
Svc Colleges (1)	11-85
USASIGS (5)	11-95
USAADS (2)	11-96
USAFAS (2)	11-97
USAARMS (2)	11-98
USAIS (2)	11-117
USAES (2)	11-237
USAICS (3)	11-500 (AA-AC)
MAAG (1)	17
USARMIS (1)	17-100
USAERDAA (1)	29-1
USAERDAW (1)	29-21
Fort Gordon (10)	29-25
Fort Huachuca (10)	29-26
Fort Carson (5)	29-35
Ft Richardson (ECOM Ofc) (2)	2 9 - 3 6
Army Dep (1) except	29-51
LBAD (14)	29-55
SAAD (30)	29-56
TOAD (14)	29-65
SGAD (3)	32-67
Fort Gillem (10)	37
USA Dep (1)	37-100
Sig Sec USA Dep (1)	39-51
	57
	57-100

NG: State AG (3); Units-Same as Active Army except allowance is one copy per unit.

USAR: None

For explanation of abbreviations used, see AR 310-50.

005192-000



SOMETHING WRONG WITH THIS MANUAL?

THEN... JOT DOWN THE DOPE ABOUT IT ON THIS FORM, TEAR IT OUT, FOLD IT AND DROP IT IN THE MAIL!

FROM: (YOUR UNIT'S COMPLETE ADDRESS)

Commander
Stateside Army Depot
ATTN: AMSTA-US
Stateside, N.J. 07703

DATE 10 July 1975

PUBLICATION NUMBER

TM 11-5840-340-12

DATE

23 Jan 74

TITLE

Radar Set AN/SPC-76

BE EXACT... PIN-POINT WHERE IT IS

IN THIS SPACE TELL WHAT IS WRONG AND WHAT SHOULD BE DONE ABOUT IT:

PAGE NO.	PARA-GRAPH	FIGURE NO.	TABLE NO.
2-25	2-28		
3-10	3-3		3-1
5-6	5-8		
		F03	

Recommend that the installation antenna alignment procedure be changed throughout to specify a 2° IFF antenna lag rather than 1°.

REASON: Experience has shown that with only a 1° lag, the antenna servo system is too sensitive to wind gusting in excess of 25 knots, and has a tendency to rapidly accelerate and decelerate as it hunts, causing strain to the drive train. Hunting is minimized by adjusting the lag to 2° without degradation of operation.

Item 5, Function column. Change "2 db" to "3db."

REASON: The adjustment procedure for the TRANS POWER FAULT indicator calls for a 3 db (500 watts) adjustment to light the TRANS POWER FAULT indicator.

Add new step f.1 to read, "Replace cover plate removed in step e.1, above."

REASON: To replace the cover plate.

Zone C 3. On J1-2, change "+24 VDC to "+5 VDC."

REASON: This is the output line of the 5 VDC power supply. + 24 VDC is the input voltage.

TYPED NAME, GRADE OR TITLE, AND TELEPHONE NUMBER

SSG I. M. DeSpirito 999-1776

SIGN HERE:

SSG I. M. DeSpirito

TEAR ALONG DOTTED LINE

RECOMMENDED CHANGES TO EQUIPMENT TECHNICAL PUBLICATIONS



THEN...JOT DOWN THE DOPE ABOUT IT ON THIS FORM. CAREFULLY TEAR IT OUT, FOLD IT AND DROP IT IN THE MAIL.

SOMETHING WRONG WITH PUBLICATION

FROM: (PRINT YOUR UNIT'S COMPLETE ADDRESS)

DATE SENT

PUBLICATION NUMBER

PUBLICATION DATE

PUBLICATION TITLE

BE EXACT PIN-POINT WHERE IT IS

PAGE NO.

PARA-GRAPH

FIGURE NO.

TABLE NO.

IN THIS SPACE, TELL WHAT IS WRONG AND WHAT SHOULD BE DONE ABOUT IT.

TEAR ALONG PERFORATED LINE

PRINTED NAME, GRADE OR TITLE AND TELEPHONE NUMBER

SIGN HERE

FILL IN YOUR
UNIT'S ADDRESS

FOLD BACK

DEPARTMENT OF THE ARMY

OFFICIAL BUSINESS

PENALTY FOR PRIVATE USE, \$300

POSTAGE AND FEES PAID
DEPARTMENT OF THE ARMY
DOD-314



Commander
US Army Electronics Command
ATTN: DRSEL-MA-Q
Fort Monmouth, New Jersey 07703

TEAR ALONG DOTTED LINE

FOLD BACK

The Metric System and Equivalents

Linear Measure

1 centimeter = 10 millimeters = .39 inch
 1 decimeter = 10 centimeters = 3.94 inches
 1 meter = 10 decimeters = 39.37 inches
 1 dekameter = 10 meters = 32.8 feet
 1 hectometer = 10 dekameters = 328.08 feet
 1 kilometer = 10 hectometers = 3,280.8 feet

Weights

1 centigram = 10 milligrams = .15 grain
 1 decigram = 10 centigrams = 1.54 grains
 1 gram = 10 decigrams = .035 ounce
 1 dekagram = 10 grams = .35 ounce
 1 hectogram = 10 dekagrams = 3.52 ounces
 1 kilogram = 10 hectograms = 2.2 pounds
 1 quintal = 100 kilograms = 220.46 pounds
 1 metric ton = 10 quintals = 1.1 short tons

Liquid Measure

1 centiliter = 10 milliliters = .34 fl. ounce
 1 deciliter = 10 centiliters = 3.38 fl. ounces
 1 liter = 10 deciliters = 33.81 fl. ounces
 1 dekaliter = 10 liters = 2.64 gallons
 1 hectoliter = 10 dekaliters = 26.42 gallons
 1 kiloliter = 10 hectoliters = 264.18 gallons

Square Measure

1 sq. centimeter = 100 sq. millimeters = .155 sq. inch
 1 sq. decimeter = 100 sq. centimeters = 15.5 sq. inches
 1 sq. meter (centare) = 100 sq. decimeters = 10.76 sq. feet
 1 sq. dekameter (are) = 100 sq. meters = 1,076.4 sq. feet
 1 sq. hectometer (hectare) = 100 sq. dekameters = 2.47 acres
 1 sq. kilometer = 100 sq. hectometers = .386 sq. mile

Cubic Measure

1 cu. centimeter = 1000 cu. millimeters = .06 cu. inch
 1 cu. decimeter = 1000 cu. centimeters = 61.02 cu. inches
 1 cu. meter = 1000 cu. decimeters = 35.31 cu. feet

Approximate Conversion Factors

To change	To	Multiply by	To change	To	Multiply by
inches	centimeters	2.540	ounce-inches	newton-meters	.007062
feet	meters	.305	centimeters	inches	.394
yards	meters	.914	meters	feet	3.280
miles	kilometers	1.609	meters	yards	1.094
square inches	square centimeters	6.451	kilometers	miles	.621
square feet	square meters	.093	square centimeters	square inches	.155
square yards	square meters	.836	square meters	square feet	10.764
square miles	square kilometers	2.590	square meters	square yards	1.196
acres	square hectometers	.405	square kilometers	square miles	.386
cubic feet	cubic meters	.028	square hectometers	acres	2.471
cubic yards	cubic meters	.765	cubic meters	cubic feet	35.315
fluid ounces	milliliters	29.573	cubic meters	cubic yards	1.308
pints	liters	.473	milliliters	fluid ounces	.034
quarts	liters	.946	liters	pints	2.113
gallons	liters	3.785	liters	quarts	1.057
ounces	grams	28.349	liters	gallons	.264
pounds	kilograms	.454	grams	ounces	.035
short tons	metric tons	.907	kilograms	pounds	2.205
pound-feet	newton-meters	1.356	metric tons	short tons	1.102
pound-inches	newton-meters	.11296			

Temperature (Exact)

°F Fahrenheit temperature 5/9 (after subtracting 32) Celsius temperature °C

PIN: 0056192-000